



# INSTRUCTION MANUAL

## ava 4 wheel stroller



Illustrations and designs may vary.



[motherschoice.com.au](http://motherschoice.com.au)



\*Suitability



Warranty



Service

# contents

## ASSEMBLING THE STROLLER

Warnings	3
Components list	4
Opening stroller	5
Installing rear axle	6
Rear wheel assembly	6
Installing front wheel	7
Attaching bumper bar	8

## USING THE STROLLER

Adjusting canopy	9
Adjusting backrest	10
Operating brakes	11
Operating footrest	12
Operating front swivel wheels	13
Folding stroller	14
Unfolding stroller	15
Carrying stroller	16
Securing your child	17
Adjusting harness height	18
Tether strap	19

## CARE AND MAINTENANCE

Care and maintenance	20
Notes	21
Product registration	23

## CONTACTS

Customer service	24
------------------	----

These instructions detail the safe use, assembly and maintenance of your product. Please read these instructions carefully and ensure that they are followed at all times. Failure to do so could result in serious injury or death.



## **WARNINGS TO AVOID INJURY OR DEATH:**

**ALWAYS APPLY THE BRAKES WHENEVER THE STROLLER IS STATIONARY.**

**FOLLOW THE MANUFACTURER'S INSTRUCTIONS.**

**DO NOT LEAVE CHILDREN UNATTENDED.**

**SECURE THE CHILD IN THE HARNESS AT ALL TIMES AND ENSURE THAT THE SAFETY HARNESS IS ADJUSTED FIRMLY BUT COMFORTABLY TO THE CHILD'S BODY.**

**DO NOT CARRY EXTRA CHILDREN OR BAGS ON THIS STROLLER.**

**MAKE SURE CHILDREN ARE CLEAR OF ANY MOVING PARTS IF YOU ADJUST THE STROLLER, OTHERWISE THEY MAY BE INJURED.**

**TO AVOID INJURY ENSURE THAT YOUR CHILD IS KEPT AWAY WHEN FOLDING AND UNFOLDING THE STROLLER.**

**ENSURE THAT ALL LOCKING DEVICES ARE ENGAGED BEFORE USE.**

Never leave safety harness connected when not fitted to a child in the stroller, as this may create loops that cause a strangulation hazard.

Never leave a child in the pram/stroller when ascending or descending stairs or escalators, or when travelling on others forms of transport.

Use the tether strap to prevent the stroller rolling away.

Do not allow children to stand on the seat or footrest.

Do not attempt to lift the stroller by the bumper bar.

Engage front wheel swivel locks when travelling on rough or uneven surfaces.

Regularly inspect all parts and locking devices, promptly replace worn out or broken parts.

Use only those accessories which are supplied by Dorel Australia and approved for use with this stroller.

To prevent the risk of the stroller catching fire, do not park it near an open fire, heater or barbecue.

Fingers or parts of the body could be injured when the stroller is being folded or unfolded. Please use caution when folding or unfolding the stroller.

This stroller has been designed for use on flat or gently sloped surfaces.

Using this stroller on uneven or higher sloped surface may cause the stroller to become unstable and tip over.

Do not run or jog with this stroller.

The weight of the child using this stroller should not be more than **17kg** (approximately 4 years of age).

Shopping basket capacity should not be more than **3kg**.

Canopy pocket **0.5kg** (max).



- |                              |                              |                            |
|------------------------------|------------------------------|----------------------------|
| Ⓐ Canopy                     | Ⓗ Seat                       | Ⓚ Adjustable backrest      |
| Ⓑ Canopy visor               | Ⓘ Adjustable footrest        | Ⓛ Viewing window           |
| Ⓒ Tether strap               | Ⓝ Wheel release buttons (x2) | Ⓜ Handle                   |
| Ⓓ Self locking storage latch | Ⓚ Front wheel (x2)           | Ⓝ Folding locks (x2)       |
| Ⓔ Bumper bar                 | Ⓛ Viewing window             | Ⓞ Storage pocket           |
| Ⓕ Harness pads (x2)          | Ⓜ Handle                     | Ⓟ Zip for canopy extension |
| Ⓖ Safety harness             | Ⓝ Folding locks (x2)         |                            |
|                              | Ⓞ Storage pocket             |                            |
|                              | Ⓟ Zip for canopy extension   |                            |
|                              |                              | Ⓠ Recline levers (x2)      |
|                              |                              | Ⓡ Shopping basket          |
|                              |                              | Ⓢ Brakes (x2)              |
|                              |                              | Ⓣ Rear wheel               |

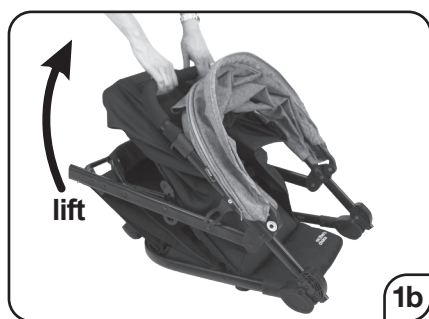
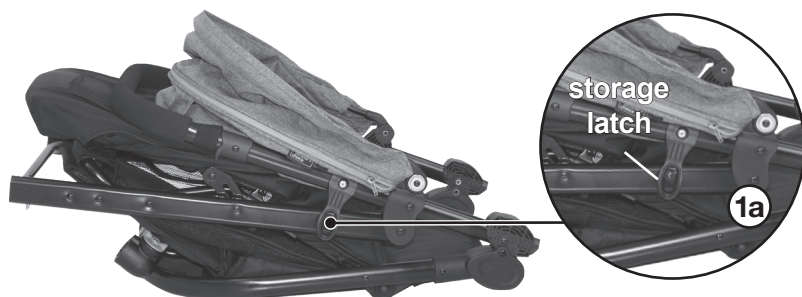

### Step 1: Opening stroller

- If the stroller has a security tie, please remove it.
- Release the storage latch (**Figure 1a**).
- Lift the handle upwards away from the rear legs (**Figure 1b**).
- Continue this action until the frame is fully open.
- When you hear a “**click**”, the stroller is opened to it’s extent and locked (**Figure 1c**).



#### mother’s choice tip...

Ensure that both the upper and lower frame locks have fully engaged before placing a child in the stroller.



## Step 2: Installing rear axle/brakes

- Insert the axle assembly into the rear stroller legs and push up until it snaps into place (**Figure 2**).

### mother's choice tip...

Ensure red brake levers face towards the rear of stroller.

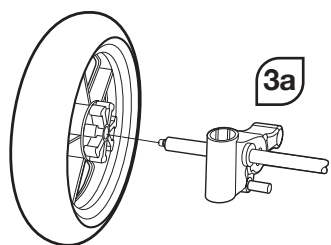

## Step 3: Rear wheel assembly

- **IMPORTANT:** Please follow the instructions carefully on this key step to ensure secure installation of wheels.
- Ensure the axle cover is removed before continuing.
- Slide the rear wheel onto the axle. Ensure the brake cogs are facing towards the axle. (**Figure 3a**)
- Press the centre button and hold the button in a lower position. (**Figure 3b**)
- Push the wheel to the end and then release the button. (**Figure 3b**)
- Pull the wheel to check if it is fastened. (**Figure 3c**)
- Repeat these steps to attach the other rear wheel.

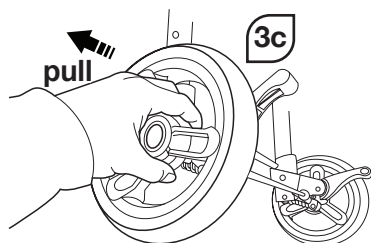
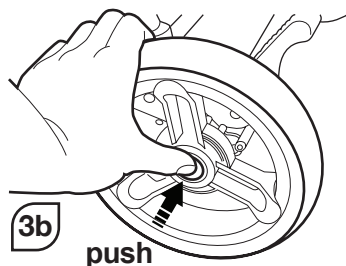

### mother's choice tip...

Release the brake pedal so the brake pin does not conflict with the wheel when assembling the rear wheels.

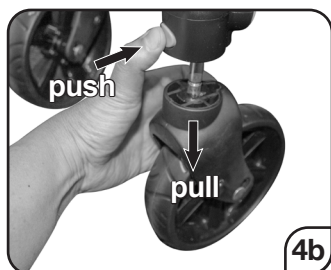
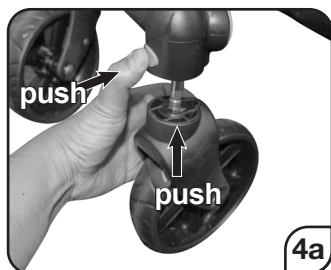

#### Step 4: Installing front wheel

- Align the shaft on the wheel with the hole in the front leg. Push in the button and simultaneously push the wheel into the hole (**Figure 4a**). Listen for a 'click'.
- Repeat for the other side.
- To remove the front wheel, push in the button inwards while pulling down (**Figure 4b**). Repeat for the other wheel.
- Repeat for the other side.

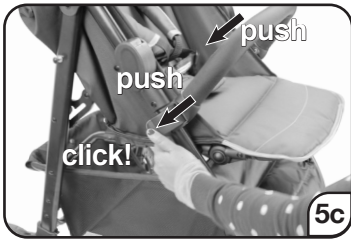

### Step 5: Attaching / removing bumper bar

- Align the bumper bar with the frame of the stroller, ensuring the arrows located on the inside of the bumper bar are facing UP (**Figure 5a**).
- Push the bumper bar onto the frame. Ensure the clamps on either side of the bumper bar sit snugly below the folding bar in the area shown in (**Figure 5b**).
- Push down on both clamps of the bumper bar simultaneously until they click firmly around the stroller frame (**Figure 5c**).
- To remove bumper bar, lift both clamps up and remove bumper bar (**Figure 5d**).





## Step 6: To adjust canopy

- Pull the front edge of the canopy to open (**Figure 6a, 6b**).
- Unzip canopy zipper and pull canopy forward (**Figure 6c**).
- Flip out visor for extra coverage (**Figure 6d**).
- To close, simply push backwards.

### mother's choice tip...

The canopy pocket maximum weight is 0.5kg.

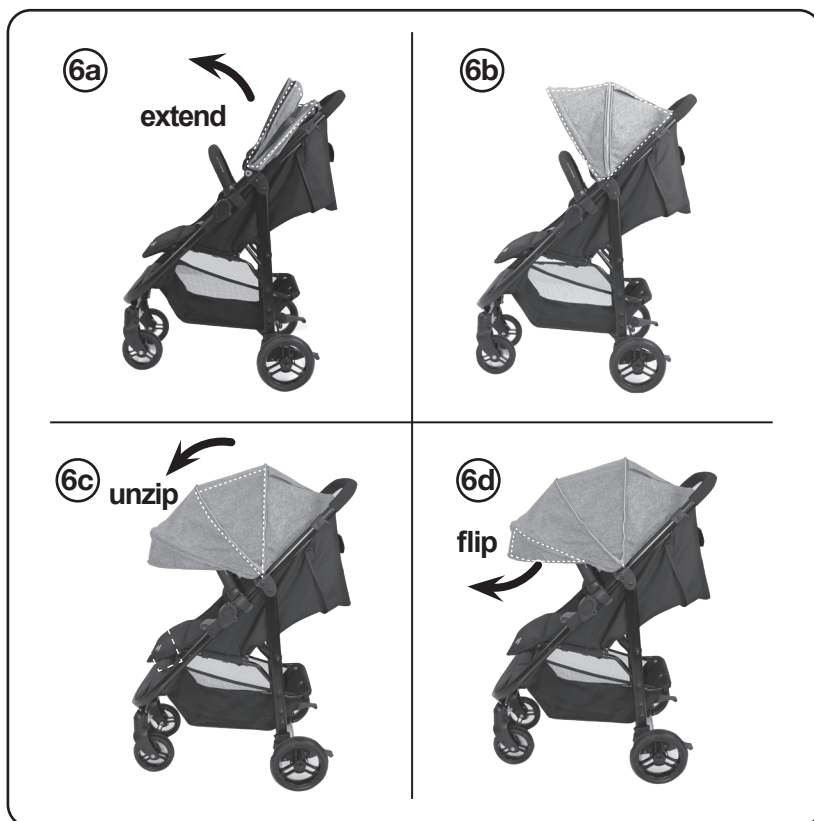



### Step 7: Operating the backrest recline lever

- Recline the backrest by simultaneously adjusting the recline levers (both sides) into one of three positions, as demonstrated in **(Figures 7a - 7d)**. To adjust upwards, simply push on the backrest.



**CAUTION**  
Do not adjust the seat back position with the child in the stroller.



**adjustable backrest**

#### **mother's choice tip...**

The backrest can be adjusted into 3 different positions.



### Step 8: Operating brakes

- To apply the brake, press down firmly on both brake pedals using the ball of your foot **(Figure 8a)**.
- Ensure both sides are engaged.
- To release the brake, lift both brake pedals until the brakes have fully disengaged **(Figure 8b)**.
- Ensure both sides are disengaged.



## WARNING

Apply all brakes whenever you park the stroller.

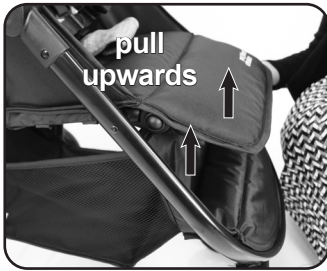

### Step 9: Operating footrest

- The footrest's default position is down.
- To raise the footrest, simply lift upwards until the footrest 'clicks' into position (**Figure 9a**).
- Ensure both sides are engaged.



- To lower the footrest, push both adjustment buttons (**Figure 9b**) simultaneously and push down gently.

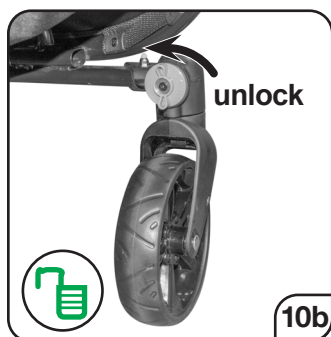
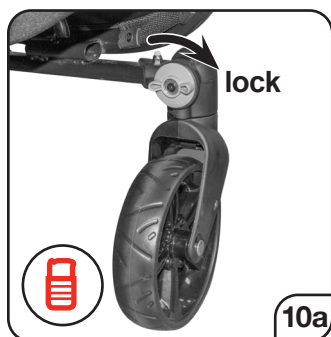

**mother's choice tip...**

Locked position is ideal for travel over rocky or uneven surfaces.

**Step 10: Operating front swivel wheels**

- To lock, turn the knob located above the front wheel anticlockwise until the indicator is horizontal (**Figure 10a**).
- To unlock, turn the knob clockwise until the indicator is vertical (**Figure 10b**).



## Step 11: Folding stroller

- Apply all brakes.
- Unlock the front swivel wheel.
- Fold the canopy back.
- Adjust the seat backrest to full layback position.
- Grip the folding locks on each side of the handle (**Figure 11b**) pull to release the lock.
- Press down on the handle to fold the stroller while pulling on the folding locks (**Figure 11c**).
- Ensure storage latch is engaged when stroller is fully folded (**Figure 11d**).

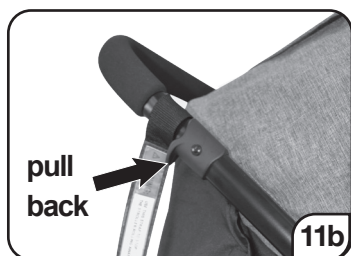

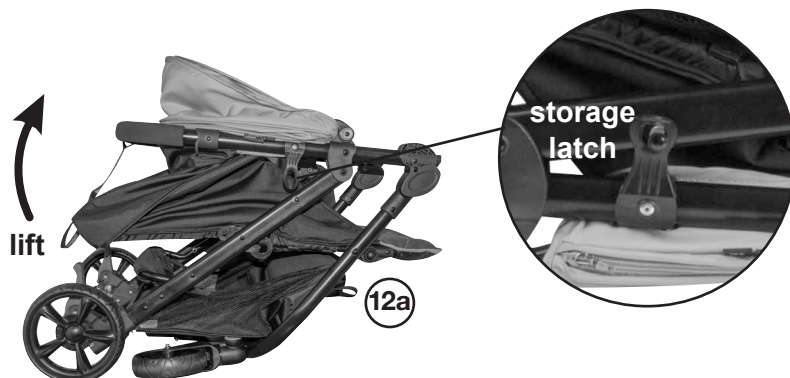

### Step 12: Unfolding stroller



- Release the storage latch (**Figure 12a**).
- Lift handle until stroller is fully open and locking mechanism engaged (**Figure 12b**).
- Push down on the handle to check that the locks have been fully engaged.

#### Caution:

- Folding strollers and accessories will always have the potential to trap fingers or parts of the body between moving parts, causing injuries. Care should be taken while folding or unfolding.



### Step 13: Carrying stroller

- Fold the stroller, and ensure that storage latch is applied before continuing.
- Carry stroller by holding frame between the storage latch and the folding lever (**Figure 13**). Avoid holding the stroller in other locations to avoid injury from moving parts.



## Step 14: Securing your child

5 points of the harness can be adjusted by moving each straps' slider (Figure A1).

To tighten or loosen the waist and/or shoulder straps, hold and lift the plastic adjuster. Adjust straps to desired position. The waist strap needs to fit firmly around the child.

1. Slip one shoulder strap (A) over each shoulder and position crotch strap between legs (B)

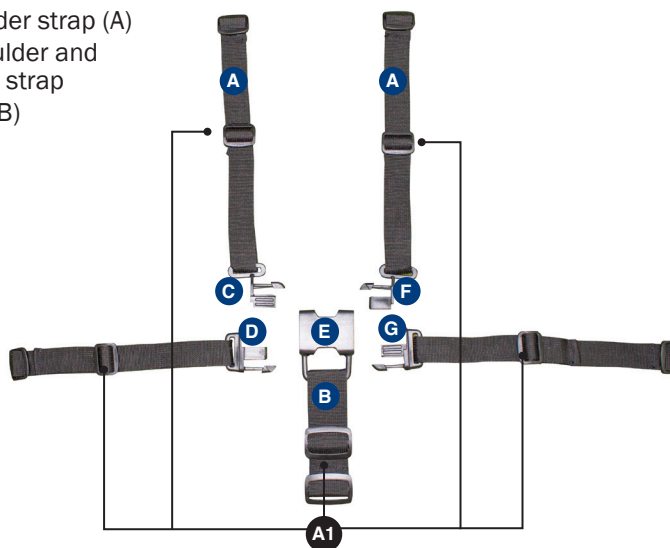

## WARNING

Use this harness at all times.

A five-point harness is provided to secure your child.

When not in use disconnect shoulder straps from the waist strap buckle.

**...securing your child**

2. Place buckle prong (D) on top of buckle prong (C)
3. Insert the prongs into the buckle housing (E) until it clicks into position. Repeat the above steps for the opposite side (F and G). Pull straps to ensure they are locked into the buckle assembly.
4. The harness should resemble this image.
5. The buckle is released by squeezing the top and bottom prongs together until harness disengages. **(Figure 5)**

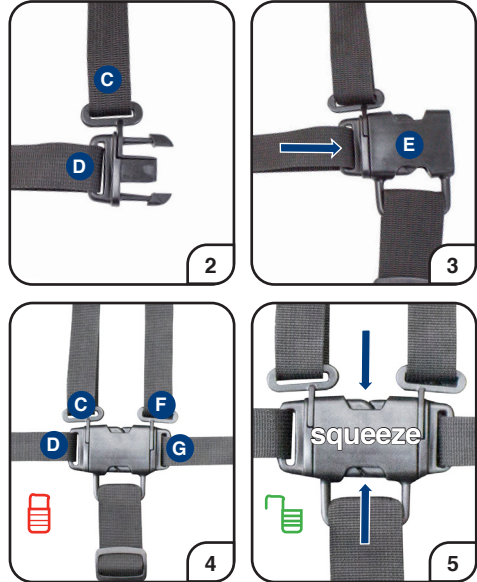

**Adjusting Harness Height**

1. Locate harness clip on the back of the seat. Push the clip through the slot to the front side of the seat. **(Figure 14a)**
2. Pull the harness clip out of the slot and the harness will come away from the seat. **(Figure 14b)**
3. Push the harness clip through the required slot on the front of the seat. **(Figure 14c)**
4. Pull the harness clip through the back side of the seat until the harness is back into position. **(Figure 14d)**
5. Repeat steps above for the remaining harness.

Please note: there are two harness positions.

### Step 15: Tether strap

- Whenever a child is in the stroller and brakes are NOT engaged, the large loop should be around your wrist (**Figure 15**).

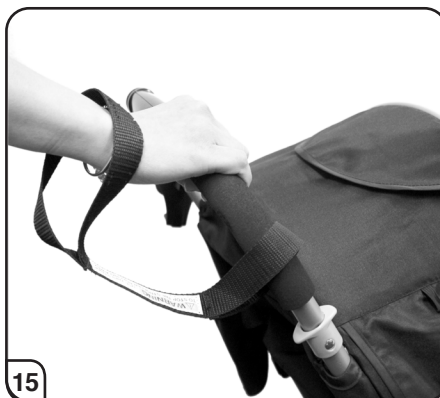

## WARNING

Use this strap to stop the stroller rolling away.

### Note:

This vehicle is designed for use on flat or gently sloping surfaces and may be unstable on higher sloping and uneven surfaces. You should always be aware of the possibility of the stroller tipping on uneven or higher sloping surfaces.

## Care and Maintenance

- Always store in a clean and dry place.
- Clean the frame by wiping with a damp cloth.
- Do not use abrasives, bleach or strong detergents.
- Spot clean fabrics with warm water and mild soap.
- Ensure fabric is dry before storing.
- Occasionally clean and lubricate wheels and axles with a light lubricating oil.
- Regularly check for loose parts and tighten when required.
- Damaged or broken parts should be immediately replaced.







[motherschoice.com.au](http://motherschoice.com.au)

### **mother's choice tip...**

Visit us online to register your new Mother's Choice product.

[www.motherschoice.com.au/product-registration](http://www.motherschoice.com.au/product-registration)

### **benefits of registration**

- Your safety - allows us to contact you with important product notifications.
- Confirmation of ownership - provides a record in case of product loss or theft.
- Improved product development - helps us continue to design products that meet your needs.

**to prevent loss or fading,  
please attach your receipt here:**



**DOREL AUSTRALIA PTY LTD**

655-685 Somerville Road  
Sunshine West Victoria 3020  
Hours: 8:30 am - 5:00 pm Mon-Fri

**Email:** [customerservice@dorel.com.au](mailto:customerservice@dorel.com.au)  
**Phone:** 1300 809 526

**IGC DOREL NEW ZEALAND LTD**

14 Sir William Avenue  
East Tamaki Auckland 2013  
Hours: 8:00 am - 5:00 pm Mon-Fri

**Email:** [customerservice@dorel.co.nz](mailto:customerservice@dorel.co.nz)  
**Phone:** 0800 628 000 (toll free)



Specifications are subject to change without notice. Copy or reproduction without permission is prohibited. © 2020 Dorel Australia Pty Ltd. All Rights Reserved.

**[www.dorel.com.au](http://www.dorel.com.au)**